

JRZ-1 SW-L358

# Electrolux Land

Poligono P-9, Fraccion F-1, Reserva San Isidro.  
Cd. Juárez, Chihuahua, México.



**American Industries**

Real Estate + Shelter

**Area = 568,060 m<sup>2</sup> / 56.8 ha / 6,114,548 Sq. Ft.**

Mexico's Leading Manufacturing Facilitator

### Competitive Advantage

- NAFTA's Central Corridor: Quality and low cost close to the largest market in the world.
- Human Capital: World-class education and stable labor force.
- Modern Infrastructure.
- Close link between academia and industry.
- Pro-Business environment.
- High Quality of life in a low cost region.



## Facility Layout

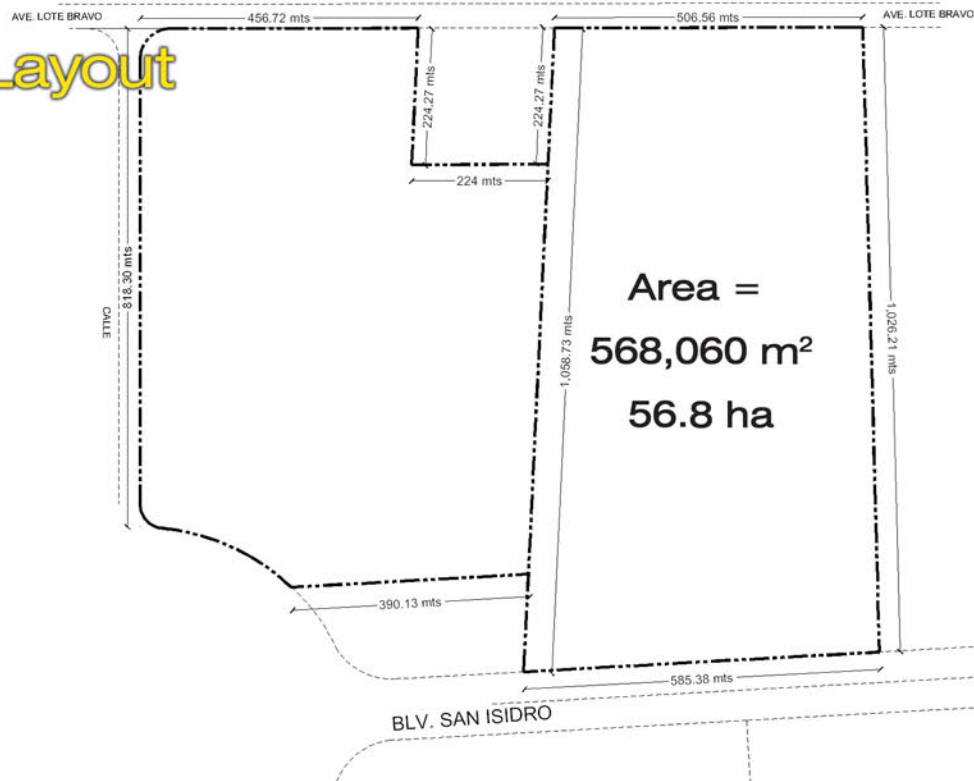

Mx + 52 656 629-2600 - [juarez@aiig.com](mailto:juarez@aiig.com) - US Toll Free 1-877-698-3905

[www.aiig.com](http://www.aiig.com)



JRZ-1 SW-L358

# Electrolux Land

Poligono P-9, Fraccion F-1, Reserva San Isidro.  
Cd. Juárez, Chihuahua, México.



**American Industries**

Real Estate + Shelter

Mexico's Leading Manufacturing Facilitator

**Area = 568,060 m<sup>2</sup> / 56.8 ha / 6,114,548 Sq. Ft.**

## Location



**Available Land Area:** 568,060 m<sup>2</sup> / 56.8 ha / 6,114,548 Sq. Ft.

**Electricity:** Available

**Water:** Available



Mx + 52 656 629-2600 - [juarez@aig.com](mailto:juarez@aig.com) - US Toll Free 1-877-698-3905

[www.aig.com](http://www.aig.com)

